

RIBBON LOAD

- ㉔ Zložení barvicí pásky
- ㉕ Farbband einlegen
- ㉖ Carga de la cinta de transferencia
- ㉗ Várnauhan asennus
- ㉘ Charge du Ruban
- ㉙ Φόρτωση μελάνωρατίδας
- ㉚ Installazione Nastro
- ㉛ リボン取り付け
- ㉜ 리본 장착
- ㉝ Lint laden
- ㉞ ZAKLADANIE TAŚMY
- ㉟ Colocação de fita de transferência
- ㊱ Υεταίωση μεταφορικής ταινίας
- ㊲ 磁帶的安裝
- ㊳ RIBON (ŞERİT) TAKMA

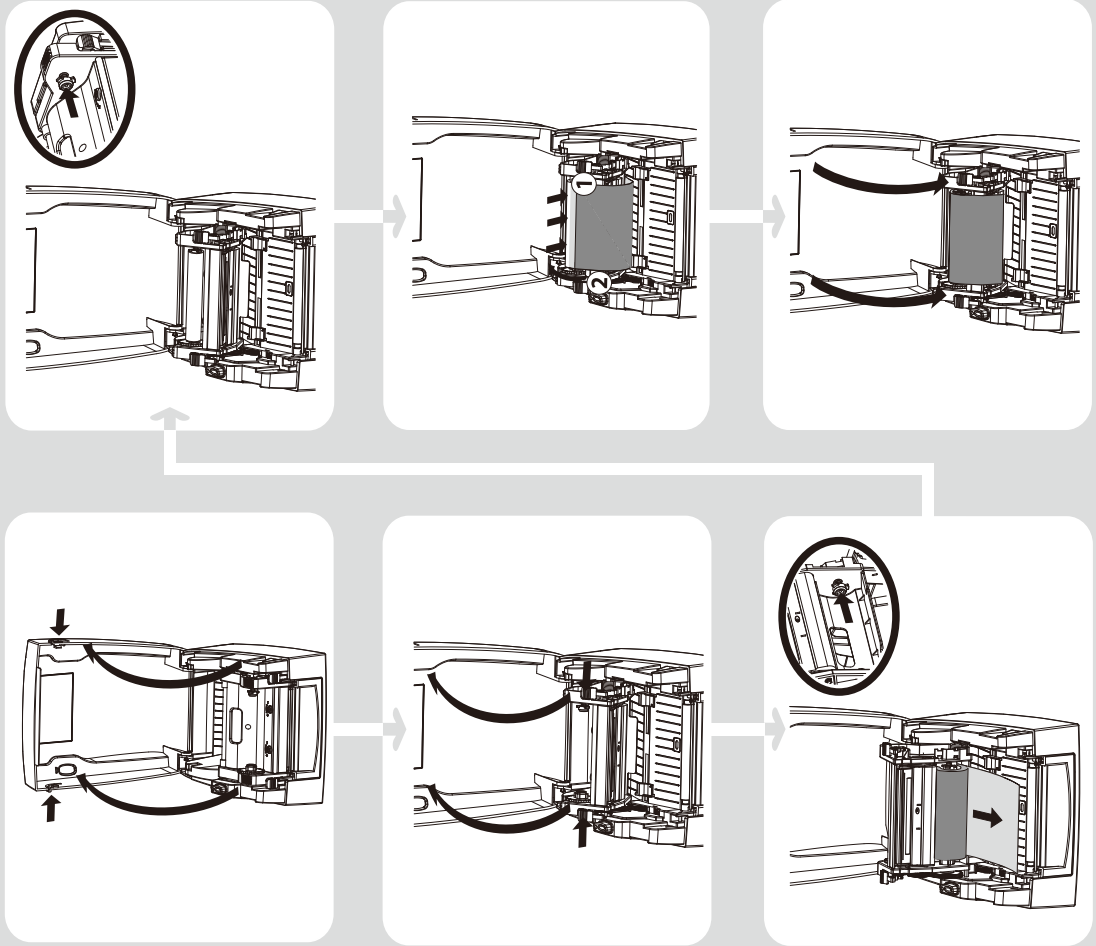

UNPACKING

- ㉔ Vybalení
- ㉕ Auspacken
- ㉖ Desembalaje
- ㉗ Pakkauksen purkaminen
- ㉘ Déballage
- ㉙ Αποσκευασία
- ㉚ Disimballaggio
- ㉛ 開梱(内容物の確認)
- ㉜ 拆箱
- ㉝ Uitpakken
- ㉞ ROZPAKOWANIE
- ㉟ Desempacotar
- ㊱ Распаковка
- ㊲ 打开包装
- ㊳ 打開包裝
- ㊴ KUTUNUN İÇİNDEKİLER

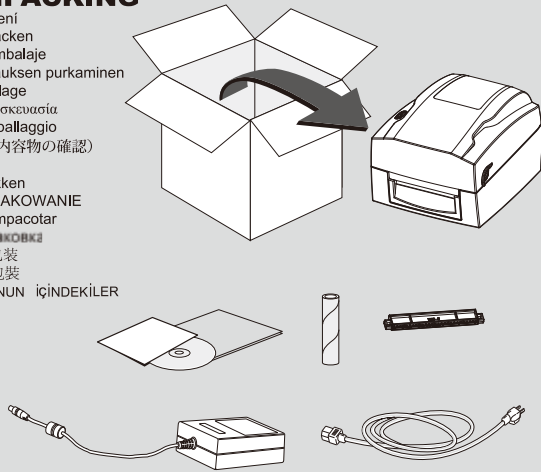

CONNECTING

- ㉔ Připojení
- ㉕ Anschließen
- ㉖ Conexiones
- ㉗ Tulostimen liittäminen
- ㉘ Branchement
- ㉙ Σύνδεση
- ㉚ Connessione
- ㉛ 接続
- ㉜ 연결
- ㉝ Aansluiten
- ㉞ PODŁĄCZENIE
- ㉟ Ligações
- ㊱ Соединение
- ㊲ 連結
- ㊳ 連結
- ㊴ BAĞLANTI ŞEKİLLERİ

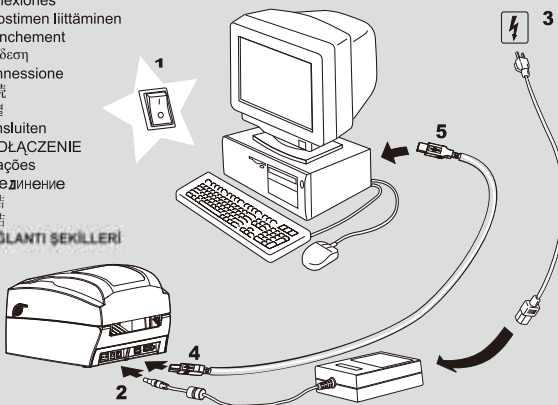

Quick Guide

EZ-1105 / EZ-1305



GODEX

PAPER LOAD

☞ Založení etiket ☞ Carga de las etiquetas ☞ Charge du papier ☞ Installazione Carta ☞ 라벨 장착 ☞ ZAKŁADANIE ETYKIET ☞ 紙的安裝 ☞ Установка этикетленты
 ☞ Etikettenmaterial einlegen ☞ Tarrarullan asennus ☞ Φόρτωση αναλωσίμου ☞ 用紙の取付け ☞ Papier laden ☞ Colocação de papel ☞ 纸的安裝 ☞ ETIKET BESLENMESİ

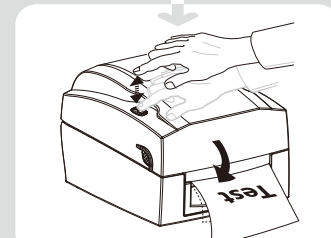
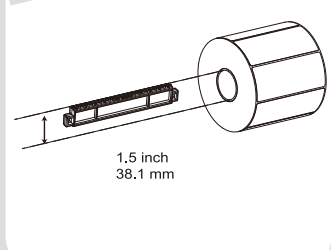
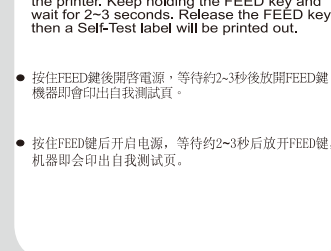
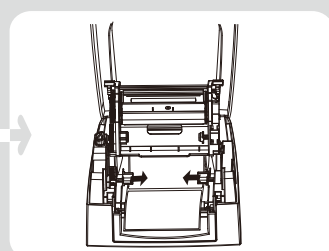
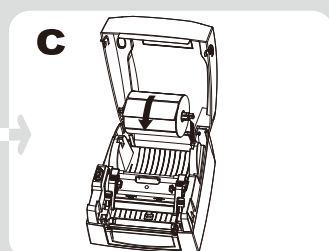
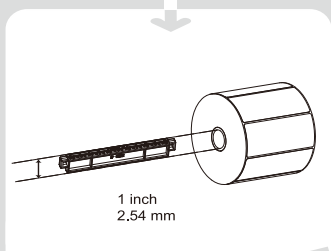
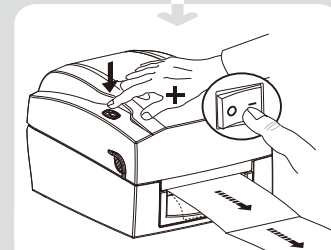
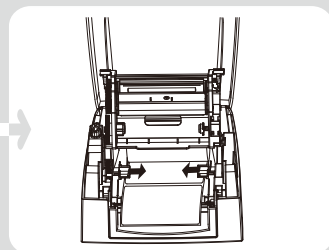
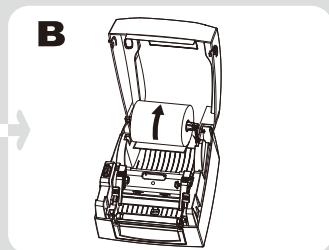
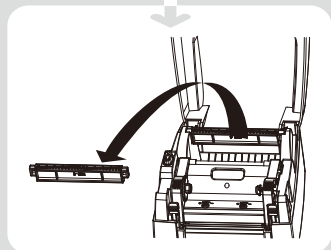
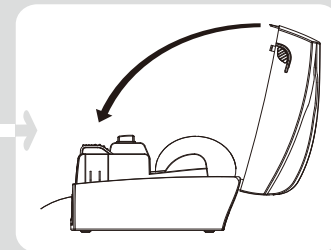
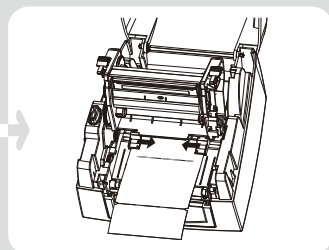
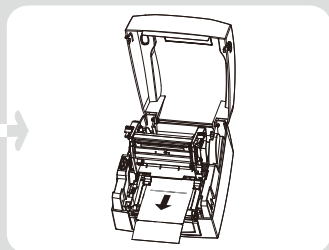
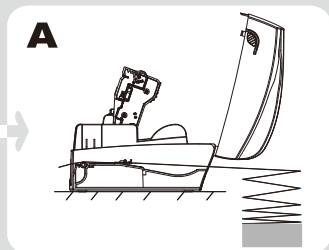
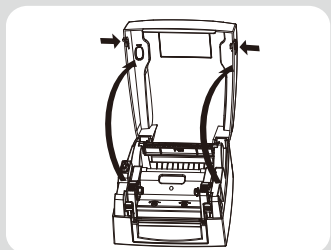

- Press and hold the FEED key then power on the printer. Keep holding the FEED key and wait for 2~3 seconds. Release the FEED key, then a Self-Test label will be printed out.
- 按住FEED鍵後開啓電源，等待約2-3秒後放開FEED鍵，機器即會印出自我測試頁。
- 按住FEED鍵后开启电源，等待约2-3秒后放开FEED键，机器即会印出自我测试页。